

# Smart Dual Plug ZP1

## User Manual



THIRD REALITY

# Contents

Specifications .....	01
Factory Reset .....	01
Features .....	02
Setting up your Smart Dual Plug .....	03
Mesh Network Setup .....	04
Using your Smart Dual Plug .....	05
Setup with SmartThings .....	06
Setup with Third Reality .....	09
Setup with 3R-Installer .....	10
Setup with Home Assistant .....	13
ISED Caution .....	20
FCC Regulatory Conformance .....	21
RF Exposure .....	22
Limited Warranty .....	22

# Specifications

Model Number	3RDP01072Z
Rated Input Voltage	110–120 V AC, 50/60 Hz
Max Combined Output Current	15A Total (shared by both outlets)
Max Combined Output Power	1800 W (at 120 V)
Wireless Connectivity	Zigbee 3.0, 2.4 GHz
Operating Environment	–10°C to 40°C, 5%–90% RH (non-condensing)

## Factory Reset

Plug the Smart Dual Plug into the power outlet and press and hold the Reset button on the left for more than 10 seconds. The LED light will flash red, indicating that your Smart Plug is in pairing mode.

# Features

1. Two sockets allow the user to control them individually, making life easier. When turning off the toaster, it can keep your coffee warm in the machine, so you don't have to worry about starting a fresh day in a rush with a cup of cold coffee.
2. The electricity bill is high, but there's no apparent reason why. Manage your devices wisely! This dual plug also features a separate power metering function, allowing for accurate tracking of small appliances without missing a penny.
3. Its compact size enables two dual plugs to fit into one standard outlet, effectively extending the number of sockets from two to four and eliminating the need for extension leads.
4. Fully Compatible with Home Assistant, SmartThings, Homey, and THIRDREALITY Smart Bridge MZ1. Partial support Thirddreality Hub Gen2 Plus.



# Setting up your Smart Dual Plug



LED Indicator	Status
Flashing red	Pairing
LED Light is out	Pairing Completed
Solid red	Power ON
LED Light is off	Power OFF

Insert the Smart Dual Plug into an outlet, it will enter pairing mode automatically.

## Pairing with compatible Zigbee hub/bridge

Compatible devices: SmartThings 2015/2018, SmartThings Station, Aeotec, Home Assistant (ZHA/Zigbee2MQTT), Third Reality Hub, Smart Bridge MZ1.

1. Update your hub firmware and phone app to the latest version before pairing, set up your Zigbee Hub by following its user manual.
2. Insert the Smart Plug into an outlet, it will enter pairing mode automatically.
3. Follow the instructions in the corresponding phone app to complete the setup.

# Mesh Network Setup

If you have multiple plugs set for different rooms, especially those located far away from your hub with poor signal quality, you can utilize a Mesh Network to extend the signal range.

1. Plug the device into the outlet that is closest to the hub, and then pair it with the hub.
2. Unplug the device and relocate it to a place with a fair to good signal quality. This device will automatically form a Zigbee Mesh Network and function as a node on the web to extend the signal range.

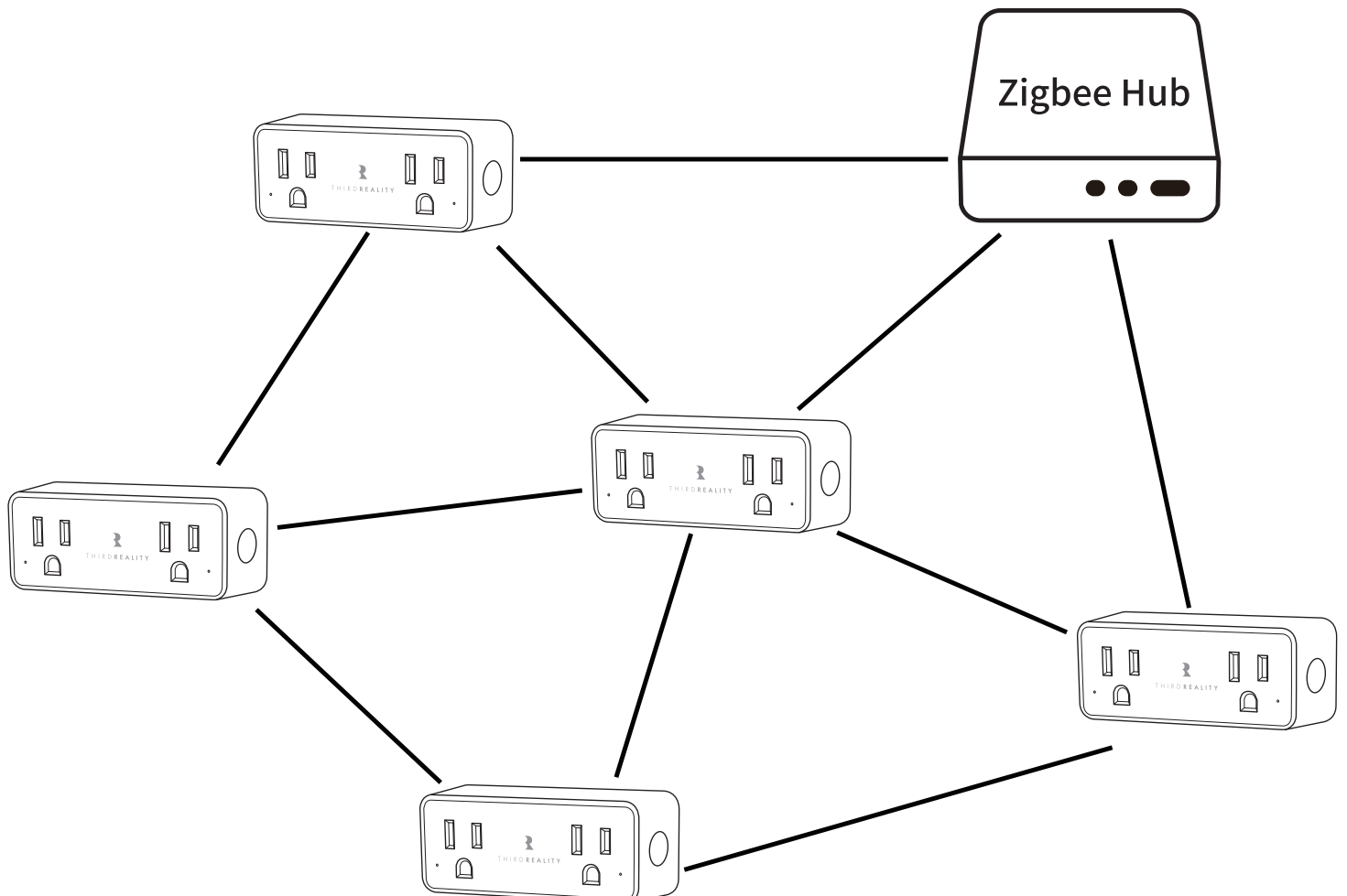

# Using your Smart Dual Plug

## 1. Independent Control and Monitoring

This Smart Dual Plug features two sockets that can be controlled and monitored separately. For example, you can turn off the toaster while keeping the coffee machine on, helping you manage your morning routine more efficiently.

## 2. Power Consumption Tracking

Each socket supports individual power metering. This allows you to monitor the electricity usage of small appliances separately, making it easier to identify energy consumption patterns. (Note: Power data is for reference only.)

## 3. Space-Saving Design

The compact form factor allows two Smart Dual Plugs to be used side by side in a standard wall outlet, expanding your available sockets from two to four without the need for extension cords.

# Setup with SmartThings

Compatible Devices:

SmartThings 2015/2018, SmartThings Station, Aeotec

App: SmartThings App



1. Check your SmartThings Hub for firmware updates before pairing the Smart Plug Gen2 with it.
2. Plug the Smart Plug Gen2 into a wall outlet close to the hub. The left LED flashes rapidly in red, indicating that it is in pairing mode. It exits pairing mode within 3 minutes if not successfully paired. To put the plug back into pairing mode, press the left button for 10 seconds until the LED indicator flashes rapidly in red again.
3. Tap "+" in the upper right corner of your SmartThings App, then tap "Scan for nearby devices." The hub will discover the Smart Dual Plug within seconds. You can see the power meter on the device page.

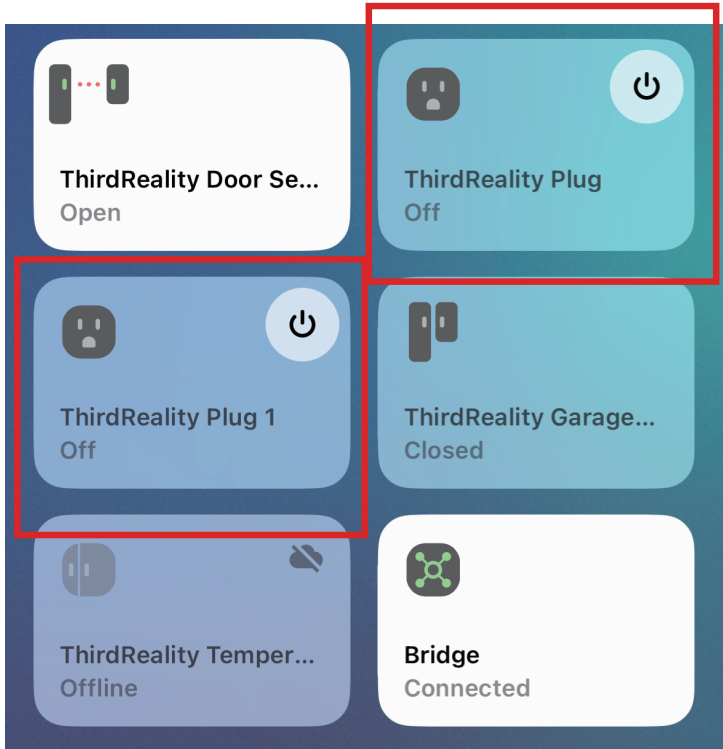
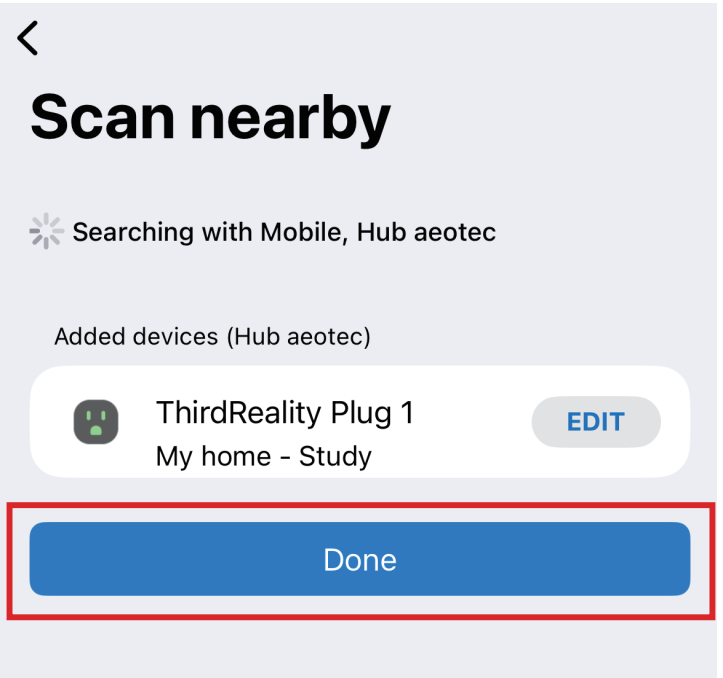
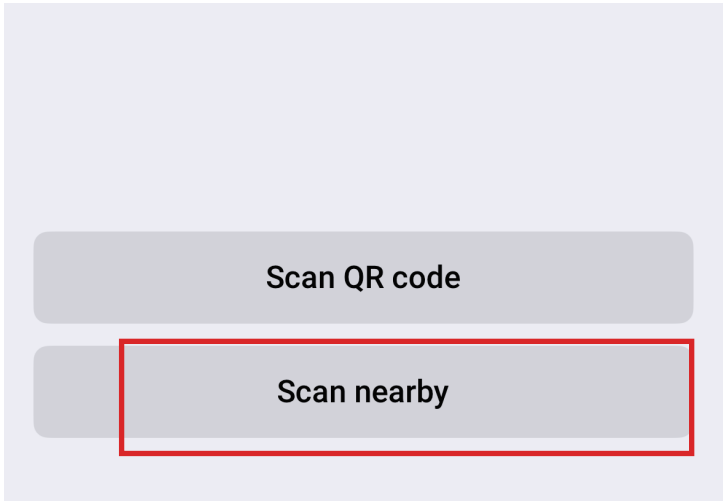
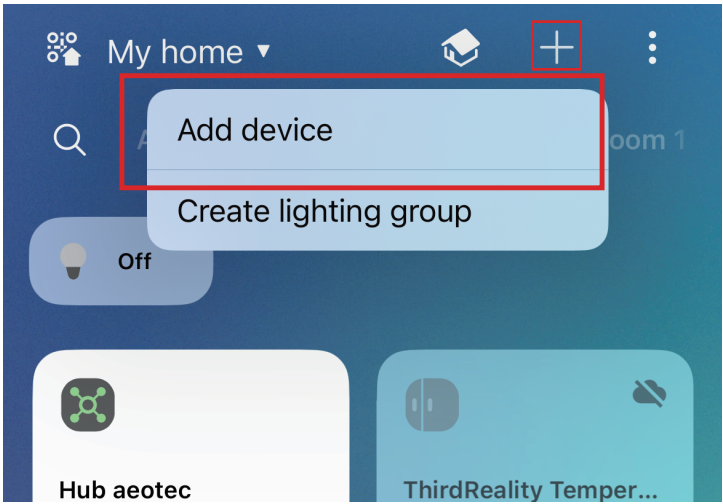

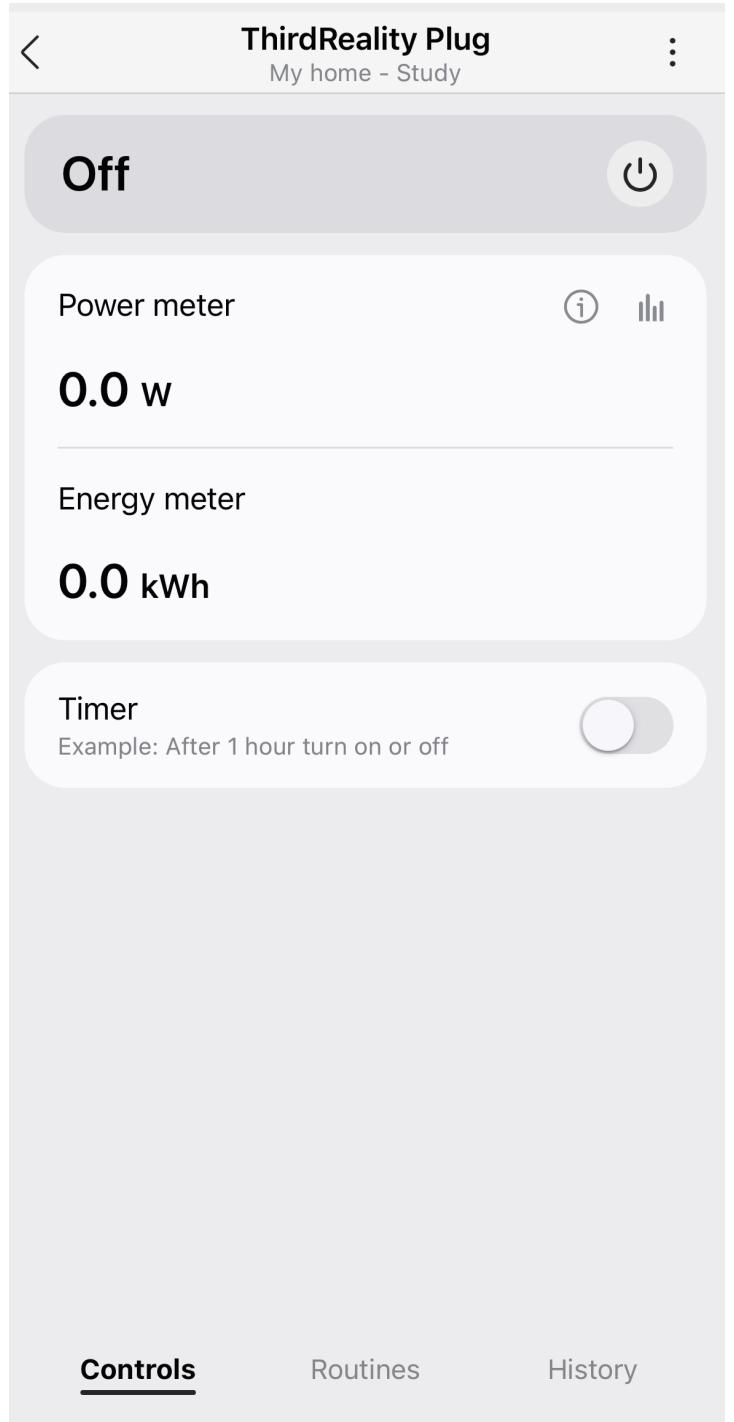
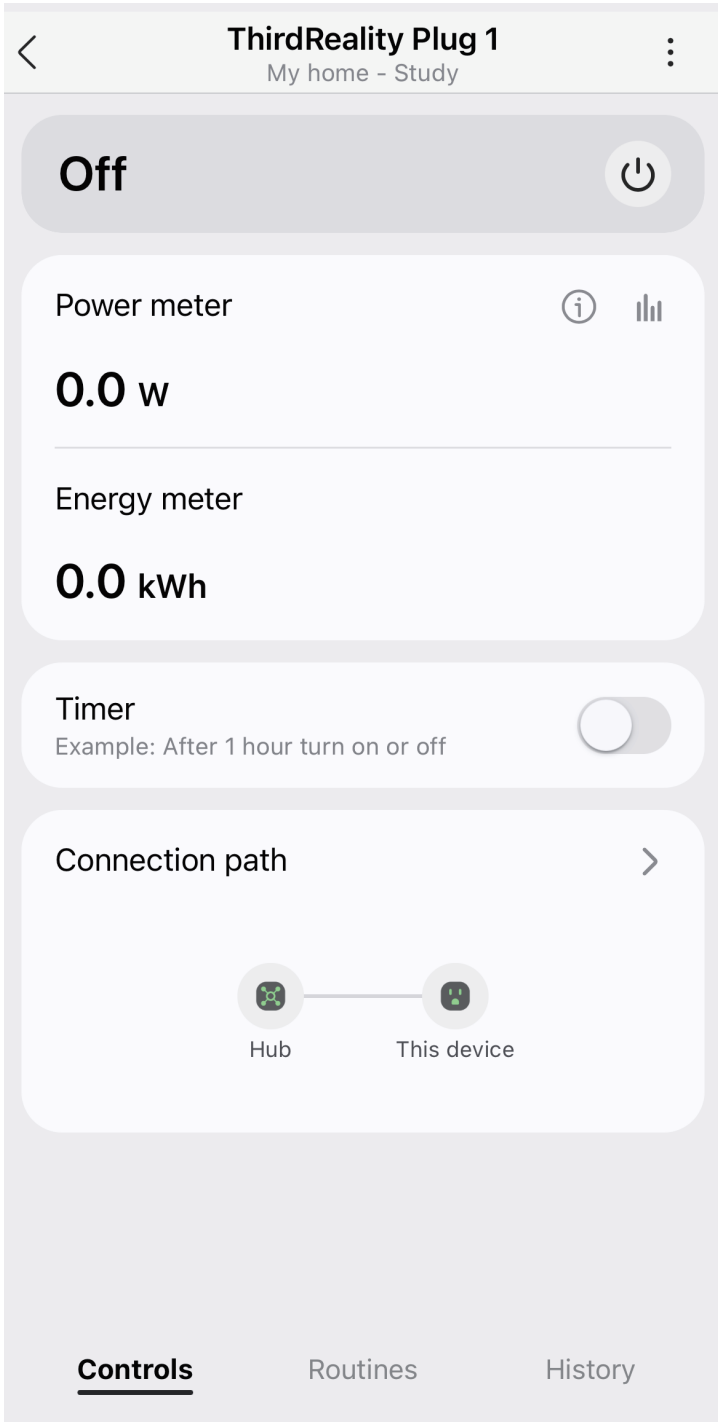

# Setup with Third Reality

Zigbee Hub: Smart Hub Gen2 Plus

App: Third Reality App

Functional compatibility notice: ONLY ONE power meter is supported



1. Check your Smart Hub Gen2 Plus's firmware and Third Reality App for updates to ensure you have the latest versions before pairing.
2. Plug the Smart Dual Plug into an outlet near the hub, and the left LED indicator flashes rapidly in red, indicating it is in pairing mode. It will exit pairing mode within 3 minutes if the pairing is not successful. Please factory reset the plug to allow it to pair again in pairing mode.
3. Tap "+" in the upright in the Third Reality App, Select the Plug icon, choose the hub you want to pair with, and then tap "Pair" to add a plug. The Smart Dual Plug will be paired within seconds. You can view the power meter and total consumption on the device detail page and customize the "Default Safety Setting" after a power outage.

# Setup with 3R-Installer

Device: Smart Bridge MZ1

App: 3R-Installer App

Functional compatibility level: Fully compatible



1. Check your Smart Bridge MZ1's firmware and 3R-Installer App for updates to ensure you have the latest versions before pairing.
2. Plug the Smart Dual Plug into an outlet near the hub, and the left LED indicator flashes rapidly in red, indicating it is in pairing mode. It will exit pairing mode within 3 minutes if the pairing is not successful. Please factory reset the plug to allow it to pair again in pairing mode.
3. Launch the 3R-Installer App, go to the bridge's detail page, and tap "+." Select "Add Devices," and then the Smart Dual Plug will be paired within seconds. You can view the power meter and total consumption on the device detail page.



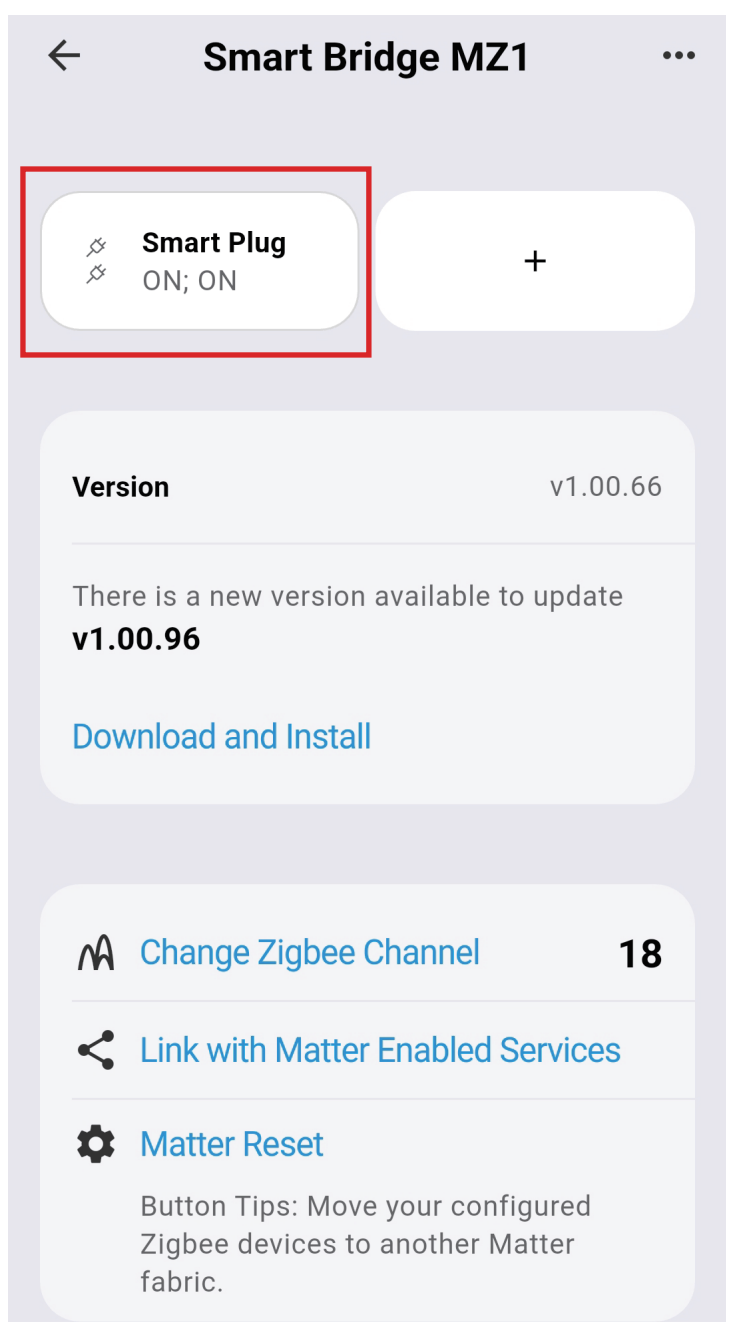
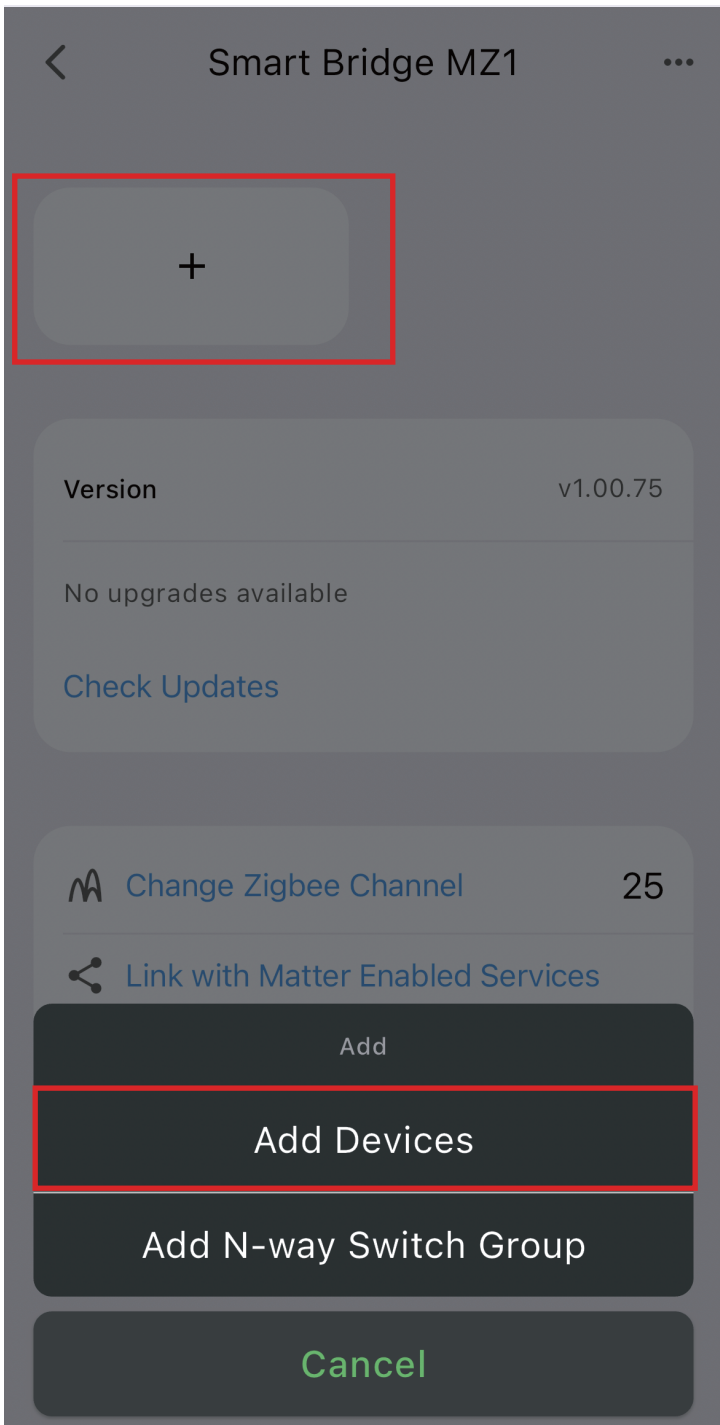
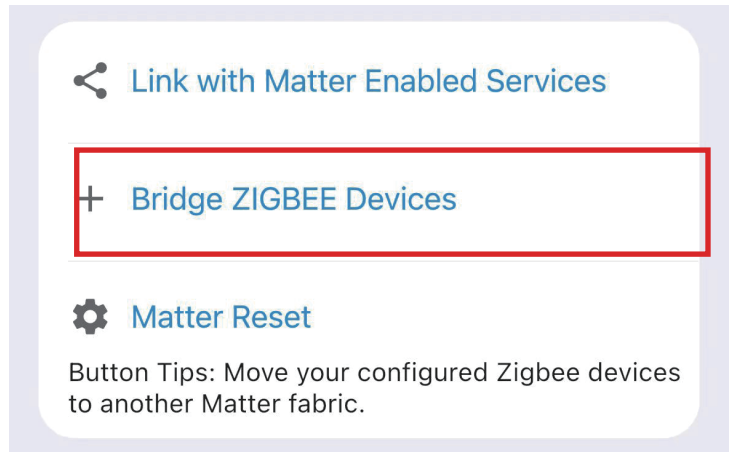
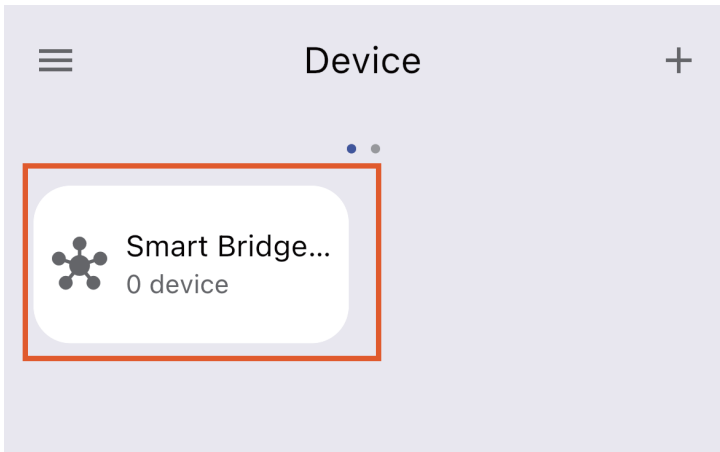

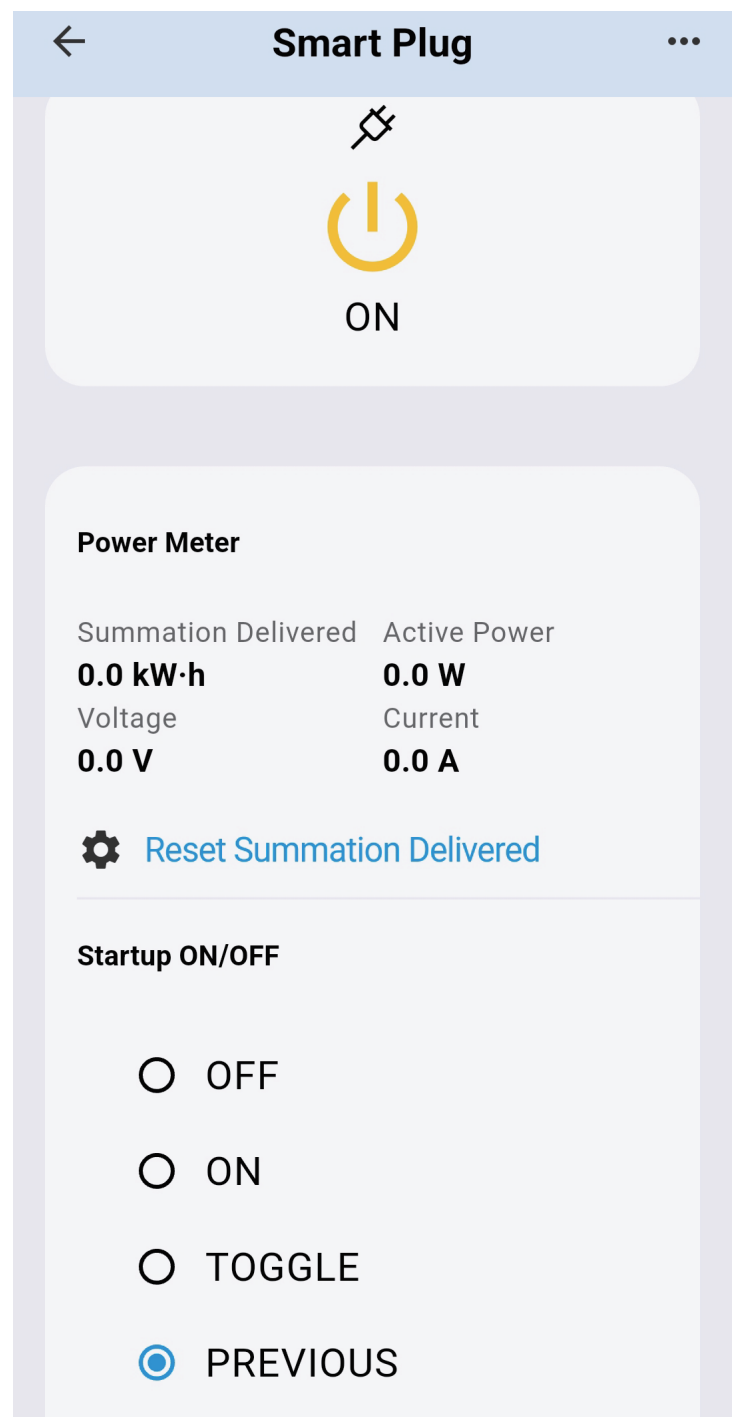
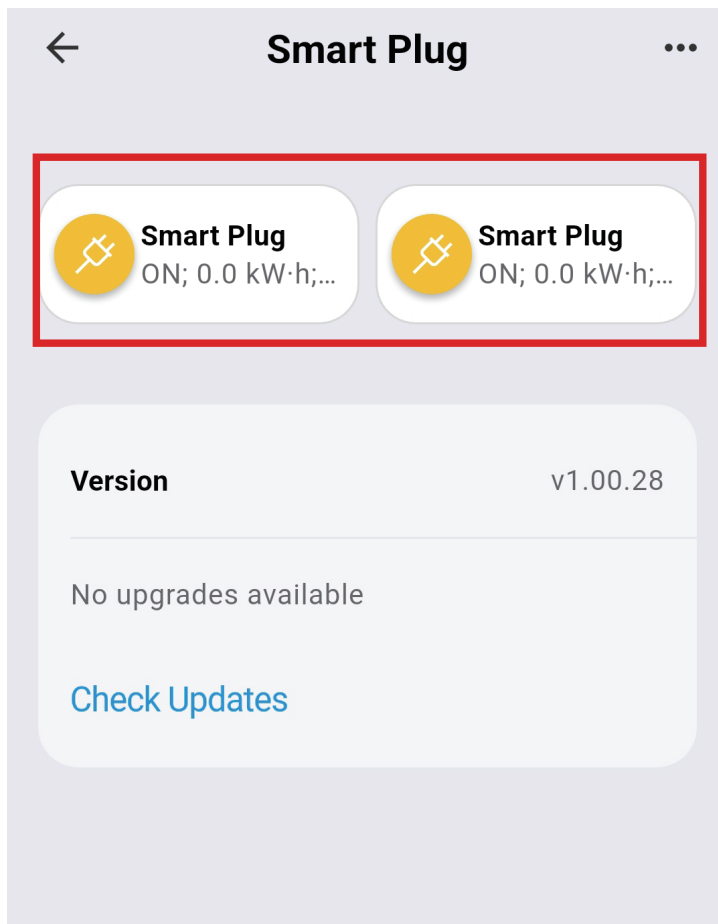

# Setup with Home Assistant Via ZHA (Zigbee Home Assistant)

Functional compatibility level: Fully compatible



1. Plug the Smart Dual Plug into an outlet near the hub, and the left LED indicator flashes rapidly in red, indicating it is in pairing mode. It will exit pairing mode within 3 minutes if the pairing is not successful. Please factory reset the plug to allow it to pair again in pairing mode.
2. Ensure the Home Assistant integration "Zigbee Home Automation" is set up correctly. Then, navigate to the "Settings" page and click "Devices & Services."
3. Click the "Devices" on the top menu, then click "Add Devices" on the bottom right, and select "Add Zigbee Devices."
4. The Smart Dual Plug will be paired within seconds. You can view the power meter, total consumption, and other information on the device detail page.

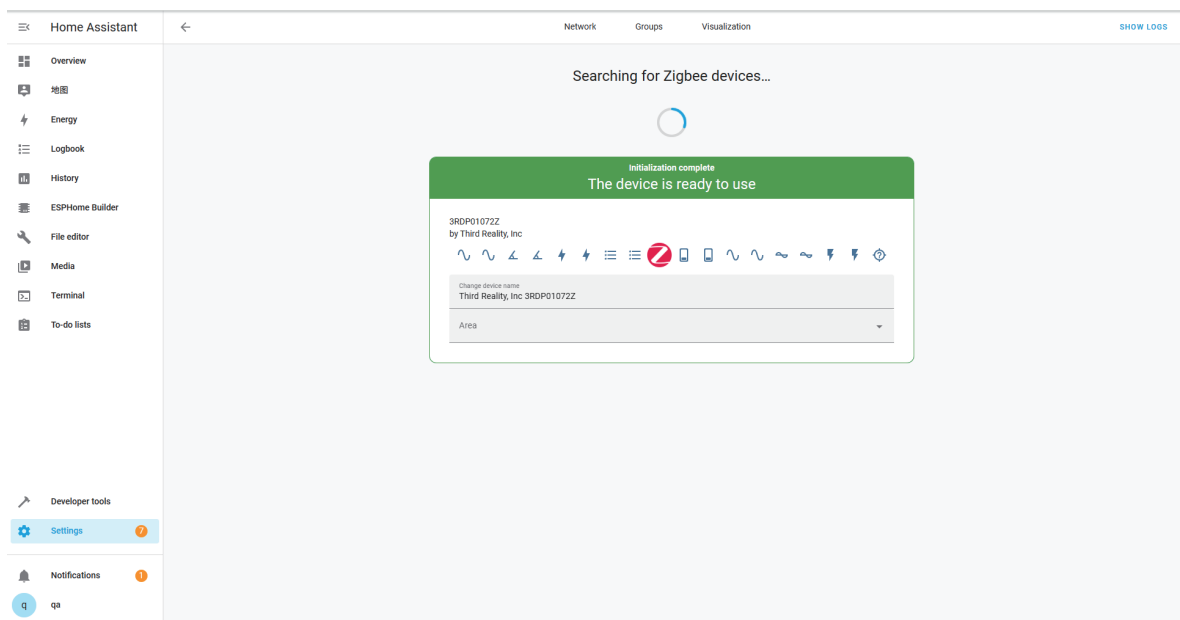
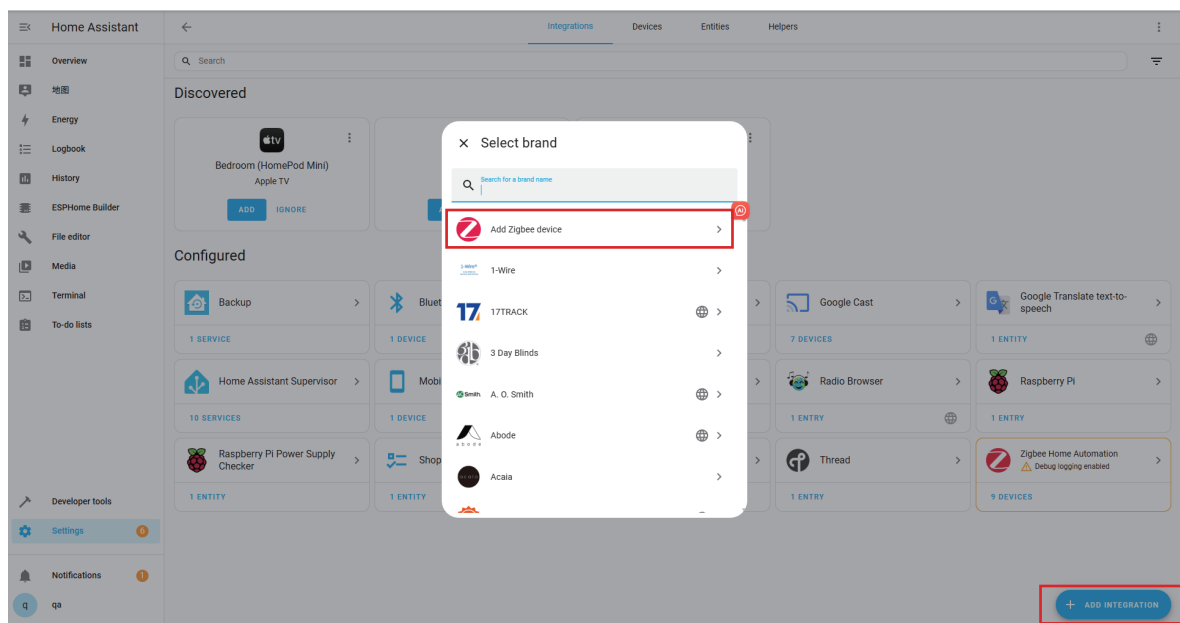
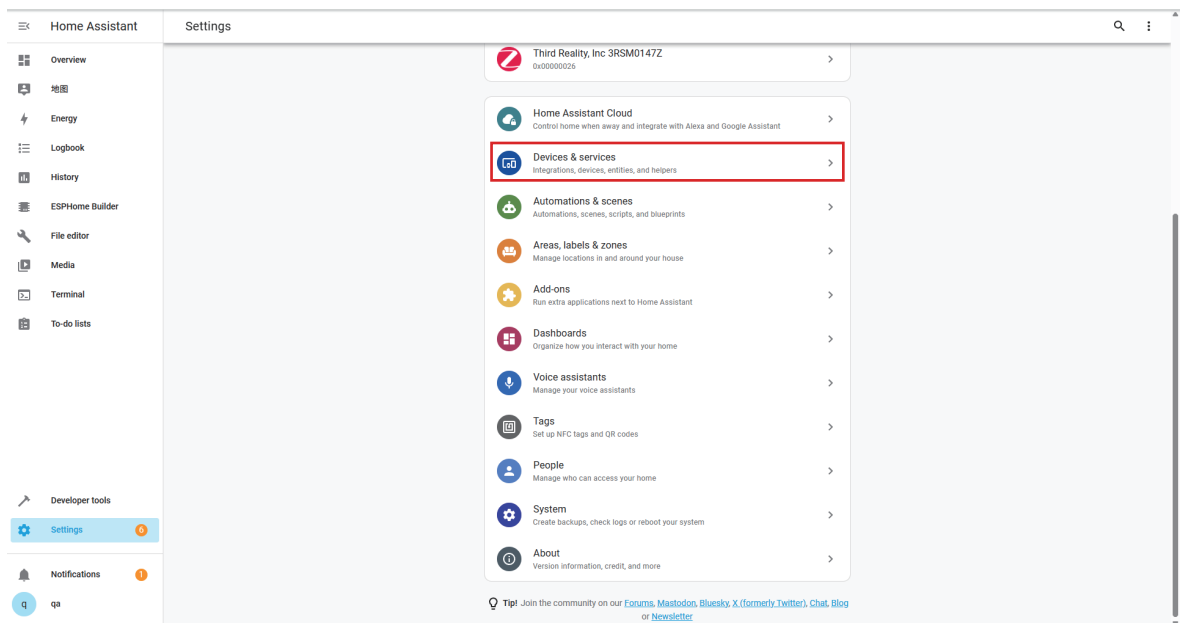

Home Assistant

Overview

地图

Energy

Logbook

History

ESPHome Builder

File editor

Media

Terminal

To-do lists

Developer tools

Settings

Notifications

qa

Integrations

Devices

Entities

Helpers

Filters

Search 111 devices

Group by

Sort by Device

Device	Manufacturer	Model	Area	Integration	Battery
2732	Third Reality, Inc	3RSM0147Z	—	Zigbee Home Automation	—
dresden elektronik Conbee II	dresden elektronik	Conbee II	—	Zigbee Home Automation	—
new 3RSB02015Z	Third Reality, Inc	3RSB02015Z	liuj	Zigbee Home Automation	—
Third Reality, Inc 3RDP01072Z	Third Reality, Inc	3RDP01072Z	—	Zigbee Home Automation	—
Third Reality, Inc 3RSB015BZ	Third Reality, Inc	3RSB015BZ	liuj	Zigbee Home Automation	—
Third Reality, Inc 3RSB015BZ old	Third Reality, Inc	3RSB015BZ	liuj	Zigbee Home Automation	—
Third Reality, Inc 3RSM0147Z	Third Reality, Inc	3RSM0147Z	—	Zigbee Home Automation	100%
Third Reality, Inc 3RSM0147Z	Third Reality, Inc	3RSM0147Z	lyr	Zigbee Home Automation	—
Third Reality, Inc 3RSMR01067Z	Third Reality, Inc	3RSMR01067Z	—	Zigbee Home Automation	78%
Third Reality, Inc 3RSPU01080Z	Third Reality, Inc	3RSPU01080Z	zhai	Zigbee Home Automation	—
Third Reality, Inc 3RTHS24BZ	Third Reality, Inc	3RTHS24BZ	—	Zigbee Home Automation	92%

ADD DEVICE

Home Assistant

Third Reality, Inc 3RDP01072Z

Overview

地图

Energy

Logbook

History

ESPHome Builder

File editor

Media

Terminal

To-do lists

Developer tools

Settings

Notifications

qa

Device info

3RDP01072Z

by Third Reality, Inc

Connected via [dresden elektronik Conbee II](#)

Zigbee info

Zigbee Home Automation

RECONFIGURE

Automations

No automations have been added using this device yet. You can add one by pressing the + button above.

Scenes

No scenes have been added using this device yet. You can add one by pressing the + button above.

Scripts

No scripts have been added using this device yet. You can add one by pressing the + button above.

Controls

On/Off

On/Off

ADD TO DASHBOARD

Sensors

AC Frequency

50 Hz

AC Frequency

50 Hz

Current

0.0 A

Current

0.0 A

Power Factor

0%

Power Factor

0%

Power Supply

0.0 W

Power Supply

0.0 W

Total Delivered

0.0 kWh

Total Delivered

0.0 kWh

Voltage

108 V

Voltage

108 V

Logbook

June 17, 2025

On/Off turned off triggered by action Switch: Turn off

11:25:10 AM - 10 minutes ago - qa

On/Off turned on triggered by action Switch: Turn on

11:25:09 AM - 10 minutes ago - qa

# Setup with Home Assistant Via Z2M (Zigbee 2MQTT)

Functional compatibility level: Fully compatible



1. Plug the Smart Dual Plug into an outlet near the hub, and the left LED indicator flashes rapidly in red, indicating it is in pairing mode. It will exit pairing mode within 3 minutes if the pairing is not successful. Please factory reset the plug to allow it to pair again in pairing mode.
2. Click "Permit Join" in Zigbee2MQTT to add devices.
3. The Smart Dual Plug will be paired within seconds. You can view the power meter, total consumption, and other information on the device detail page.

Home Assistant

Overview

地图

Energy

Logbook

History

File editor

HACS

Media

Terminal

Zigbee2MQTT

Developer tools

Settings

Notifications

admin

ZZM@192.168.3.41

Devices

Dashboard

Map

Groups

OTA

Touchlink

Logs

Extensions

Permit join (All)

Enter search criteria

#	Pic	Friendly name	IEEE Address	Manufacturer	Model	LQI	Availability	Power	
1		0xffffb40e0601de8f	0xffffb40e0601de8f (0xc888)	Third Reality	3RSM0147Z	N/A	Offline	?	
2		0x282c02bfffed00eb	0x282c02bfffed00eb (0x2077)	Third Reality	3RMS168Z	N/A	Offline	?	

Home Assistant

Overview

地图

Energy

Logbook

History

File editor

HACS

Media

Terminal

Zigbee2MQTT

Developer tools

Settings

Notifications

admin

ZZM@192.168.3.41

Devices

Dashboard

Map

Groups

OTA

Touchlink

Logs

Extensions

Disable join (All) 03:41

Enter search criteria

#	Pic	Friendly name	IEEE Address	Manufacturer	Model	LQI	Availability	Power	
1		0xffffb40e0601de8f	0xffffb40e0601de8f (0xc888)	Third Reality	3RSM0147Z	208	Offline		
2		0x282c02bfffed00eb	0x282c02bfffed00eb (0x2077)	Third Reality	3RMS168Z	240	Online		
3		0x00003b20df74e14c	0x00003b20df74e14c (0x34A4)	Third Reality	3RDP01072Z	216	Online		

z2m: Configuring '0x00003b20df74e14c'

z2m: Device '0x00003b20df74e14c' is supported, identified as: Third Reality Smart Dual Plug ZP1 (3RDP01072Z)

z2m: Successfully interviewed '0x00003b20df74e14c', device has successfully been paired

zhc:controller: Successfully interviewed '0x00003b20df74e14c'

Home Assistant

Overview

地图

Energy

Logbook

History

File editor

HACS

Media

Terminal

Zigbee2MQTT

Developer tools

Settings

Notifications

admin

Z2M@192.168.3.41

Devices

Dashboard

Map

Groups

OTA

Touchlink

Logs

Extensions

Disable join (All) 03:20

0x00003b20df74e14c

About

Exposes

Bind

Reporting

Settings

Settings (specific)

State

Clusters

Scene

Dev console



Friendly name

Description

Last seen

Availability

Device type

Zigbee Model

Zigbee Manufacturer

Description

Support status

IEEE Address

Network address

Firmware build date

Firmware version

Manufacturer

Model

Power

Interview state

0x00003b20df74e14c

N/A

Online

Router

3RDP01072Z

Third Reality, Inc.

Smart Dual Plug ZP1

Supported

0x00003b20df74e14c

0x34AA / 13A76

20250506-3R

v1.00.15

Third Reality

3RDP01072Z

Successful

Home Assistant

Overview

地图

Energy

Logbook

History

File editor

HACS

Media

Terminal

Zigbee2MQTT

Developer tools

Settings

Notifications

admin

Z2M@192.168.3.41

Devices

Dashboard

Map

Groups

OTA

Touchlink

Logs

Extensions

Disable join (All) 03:04

Linkquality

216

Link quality (signal strength)

State

On/off state of the switch

OFF

ON

Power-on behavior

Controls the behavior when the device is powered on after power loss

off

on

toggle

previous

Power

Instantaneous measured power

0 W

Voltage

Measured electrical potential value

108.3 V

AC frequency

Measured electrical AC frequency

50 Hz

Power factor

Instantaneous measured power factor

0

Current

Instantaneous measured electrical current

0 A

Energy

Sum of consumed energy

0 kWh

State

On/off state of the switch

OFF

ON

Power-on behavior

Controls the behavior when the device is powered on after power loss

off

on

toggle

previous

Power

Instantaneous measured power

0 W

Voltage

Measured electrical potential value

108.3 V



# Troubleshooting

## 1. **Factory reset the Smart Dual Plug**

Plug the Smart Dual Plug into the power outlet and press and hold the Reset button on the left for more than 10 seconds. The LED light will flash red, indicating that your Smart Plug is in pairing mode.

## 2. **What happens to the Smart Dual Plug after a factory reset? Will both sockets be affected?**

Yes. Performing a factory reset will reset both plugs at the same time. All settings will be restored to default, and any accumulated power consumption data will be cleared for both sockets. This operation cannot be undone.

# ISED Caution

This device complies with Innovation, Science and Economic Development Canada (ISED) licence-exempt RSS standard(s). Operation is subject to the following two conditions: (1) This device may not cause harmful interference, and (2) this device must accept any interference received, including interference that may cause undesired operation.

Cet appareil est conforme à la ou aux normes RSS exemptées de licence pour Innovation, Science et développement économique Canada. Le fonctionnement est soumis aux deux conditions suivantes: (1) ce dispositif ne peut pas causer d'interférence nocive, et (2) ce dispositif doit accepter toute interférence reçue, y compris les interférences pouvant causer un fonctionnement indésirable.

This equipment complies with ISED radiation exposure limits set forth for an uncontrolled environment. This equipment should be installed and operated with minimum distance 20cm between the radiator and your body. This transmitter must not be co-located or operating in conjunction with any other antenna or transmitter.

Cet équipement respecte les limites d'exposition aux rayonnements ionisants fixées pour un environnement non contrôlé. Cet équipement doit être installé et utilisé avec une distance minimale de 20cm entre le radiateur et votre corps. Cet émetteur ne doit pas être localisé ou fonctionner en conjonction avec une autre antenne ou un autre émet-

# FCC Regulatory Conformance

This device complies with Part 15 of the FCC Rules. Operation is subject to the following two conditions:

- (1) This device may not cause harmful interference.
- (2) This device must accept any interference received, including interference that may cause undesired operation.

**NOTE:** This equipment has been tested and found to comply with the limits for a Class B digital device, pursuant to part 15 of the FCC Rules. These limits are designed to provide reasonable protection against harmful interference in a residential installation.

**NOTE:** This equipment generates uses and can radiate radio frequency energy and, if not installed and used in accordance with the instructions, may cause harmful interference to radio communications. However, there is no guarantee that interference will not occur in a particular installation. If this equipment does cause harmful interference to radio or television reception, which can be determined by turning the equipment off and on, the user is encouraged to try to correct the interference by one or more of the following measures:

- Reorient or relocate the receiving antenna.
- Increase the separation between the equipment and receiver.
- Connect the equipment into an outlet on a circuit different from that to which the receiver is connected.
- Consult the dealer or an experienced radio/TV technician for help.

**NOTE:** The manufacturer is not responsible for any radio or TV interference caused by unauthorized modifications to this equipment. Such modifications could void the user's authority to operate the equipment.

## **RF Exposure**

This equipment complies with FCC radiation exposure limits set forth for an uncontrolled environment.

This transmitter must not be co-located or operating in conjunction with any other antenna or transmitter.

## **Limited Warranty**

For limited warranty, please visit

<https://3reality.com/faq-help-center/>

For customer support, please contact us at [info@3reality.com](mailto:info@3reality.com) or visit [www.3reality.com](http://www.3reality.com)

For question on other platforms, visit for corresponding platform's application/support platforms.